



IFI Model FGH48B Glass Door Freezer Ice Cream and Frozen Food





IFI Model FGH48B Glass Door Freezer Ice Cream and Frozen Food

Standard Features:

- Energy Efficient Reversible Doors by Tecnodor.
- Full Length Extruded Aluminium handle.
- Low E Glass Technology.
- Bottom Mount Pull-Out Unit for Superior customer accessibility.
- R134A Refrigerant.
- Digital Electronic Control, easy to read, easy to set.
- Self Closing with hold open assembly for loading.
- Evaporative Condensing Unit.
- ETL approved, UL pending.
- Door and Frame Etched Clear satin Finish.
- Slim line evaporative Coil for maximum Interior.
- Exterior Standard Finish Black or White.
- Standard 4 Rows wire shelves not including base deck.
- Available in 1, 2, 3 and 4 door versions.
- Optional: Energy saving LED Lighting with superior life span.

FGH48B Model

	Volts	Amps	Hz	PH
Amps Lights	120	.08	60	1
A/S Htrs	120	4.1	60	1
Fans	240	1.2	60	1
Defrost Htr	240	5.00	60	1

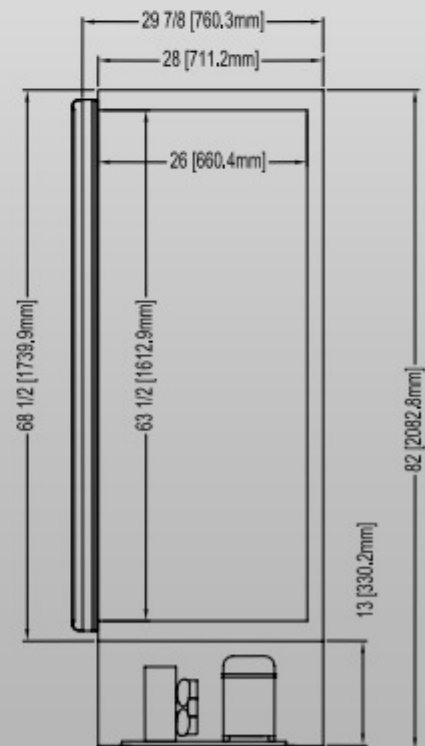
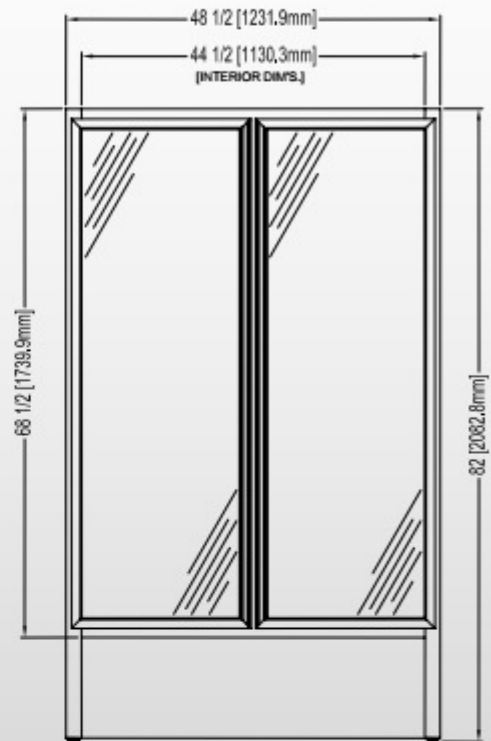
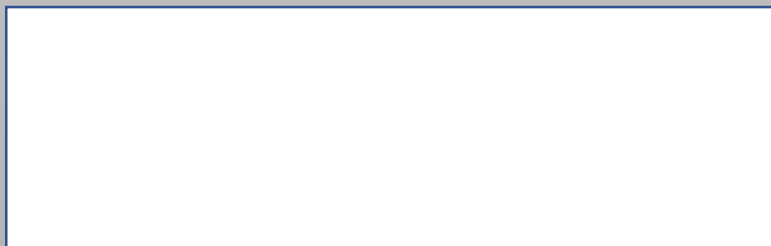

Note : Les spécifications sont sujettes à changements sans préavis. Specifications are subject to change without notice.